

# Specification MAM0240 Series



## Key Features

- Form, fit and function replacement for Farnell G 240W range and Advance MG 240W range
- 90-264VAC operation
- Connections as original G and MG range
- Complete transparency to end user
- Does not support remote voltage programming



## Specifications

### Input specification

Input voltage Range	90-264V AC
Frequency	47 to 63Hz.
Inrush current	20/40A (100/200VAC)
Operating Current	4.0/2.0A (100/200VAC)
Efficiency	Typically 85% at full load.
Power factor	0.95 minimum. Meets EN61000-3-2.
EMI-filter standard	CISPR 22, EN55022 "A".
Radiated EMI	CISPR 22, EN55022 "A".
Holdup time (typ)	20ms
Harmonic Distortion	Meets EN61000-3-2.
Isolation	Meets EN60950.

### Output specification

Overall regulation	Less than 0.1%
Ripple pk-pk (20MHz bandwidth)	<50mV
Current limit	>125 – 150% of rated output current (constant current limit)
Protection	Protected for continuous short circuit
Oversvoltage protection	125-145% of nominal output Cycle AC input to reset.
Remote sense	Remote sense available. Local sense links fitted as standard.
Voltage Programming	Not supported
Minimum load	Not required
Indicators	Output ON LED

### General

Cooling	Convection
Operating temperature	0°C to 70°C. For 50°C to 70°C, de-rate output by 2.5% per °C
Weight	2.2kg

# Specification

## Mechanical Outline

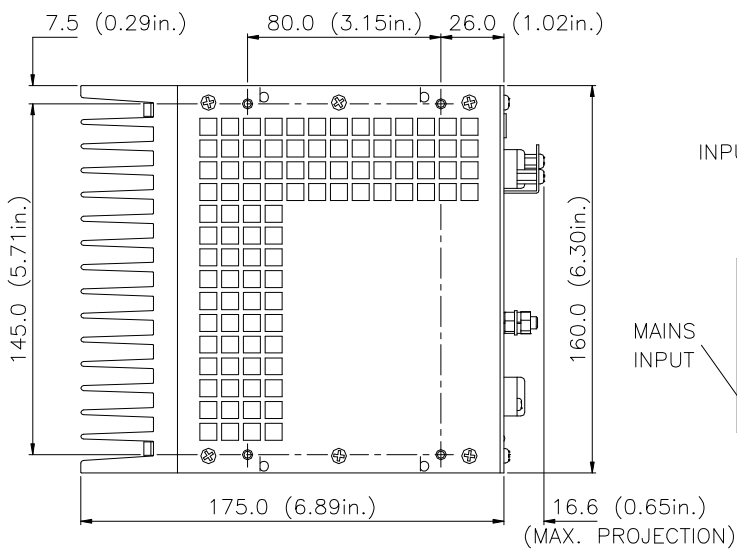
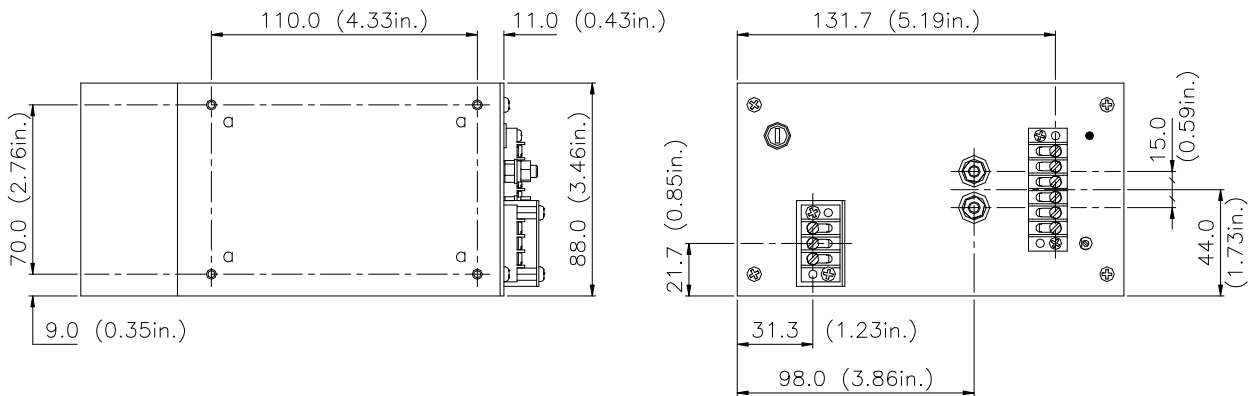

- a - 4 x M3 FIXINGS (SIDES)
- b - 4 x M3 FIXINGS (BASE)

